

Corner Flash with a Pig Ear Fold detail for Recessed Window Flashing

CORNER FLASH BY TLS LABORATORIES

GS 108 A piece
Out of the box

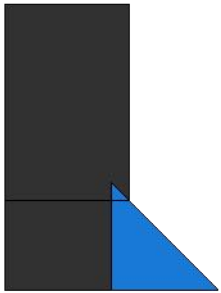

GS 108 A piece
Fold Line

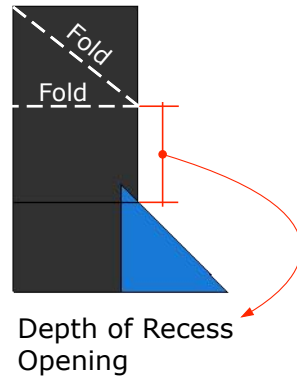

GS 108 A piece Unfolded

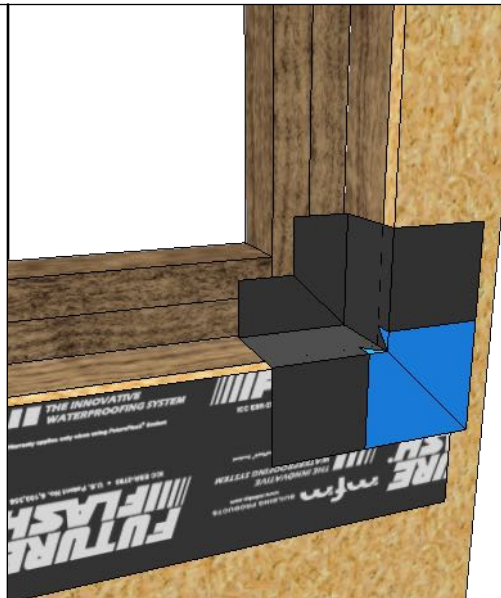
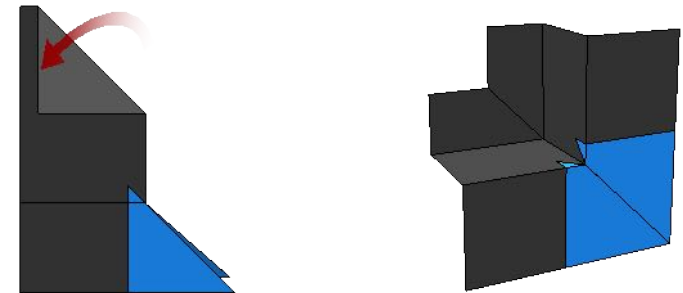

STEP 1

Apply Apron

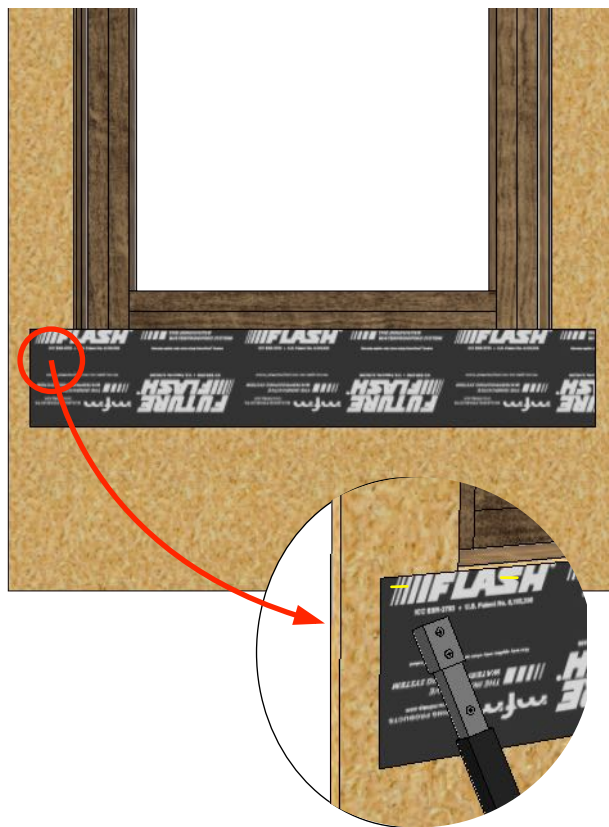

NOTE:

Apply your apron using 9" Future Flash. Keep staples tight to the top edge of the flashing

STEP 2

Apply Sealant



NOTE:

Apply your sealant as shown using Future Flash Sealant.

STEP 3

Apply GS 108 A Corners

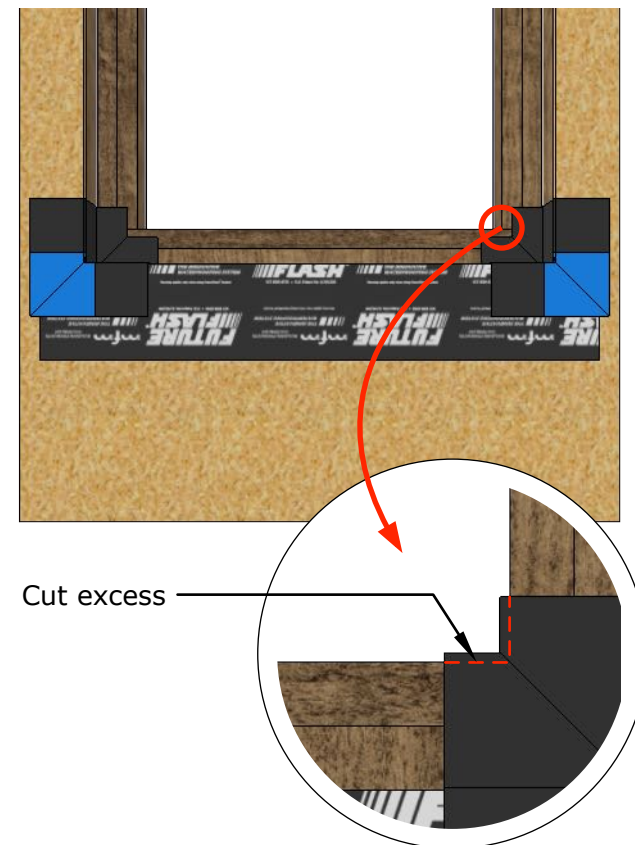

NOTE:

Apply your Pig Ear folds and install the GS 108 A corners into the wet sealant as shown.
If the material extends into the RO trim it with a razor knife.
Use a J-Roller and J-Roll the material flat.

STEP 4

Layer SubSeal 40 Membrane into place.



NOTE:

Depending on your depth of recess, place a mark on the wall at the point where the top of the flashing needs to be applied. Apply your flashing and staple the top edges onto the wall. Then cut the membrane as shown and carefully layer back into place. J-Roll the material to ensure complete adhesion and eliminate wrinkles.

STEP 5

Apply End Dams



NOTE:

Cut 9" x 9" or larger corners out of your SubSeal 40 to be used as End Dams. Use a J-Roller and J-Roll the material flat.

STEP 6

Apply End Dams and Sealant



NOTE:

Apply your end dams and sealant as shown. Tool the sealant flat.

STEP 7

Apply window flashing

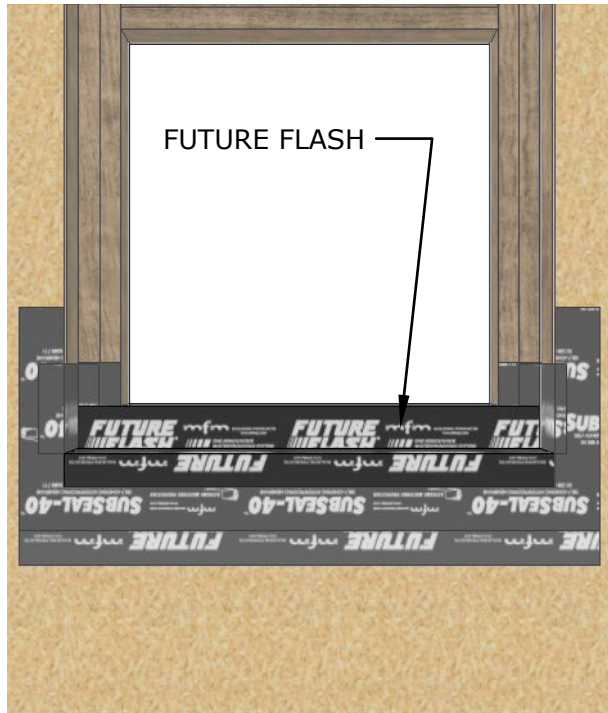

NOTE:

Using Future Flash apply the lower course of window flashing on the lower edge of the RO

STEP 8

Apply Side Flashing



NOTE:

Using Future Flash apply your side flashing

STEP 9

Install Window

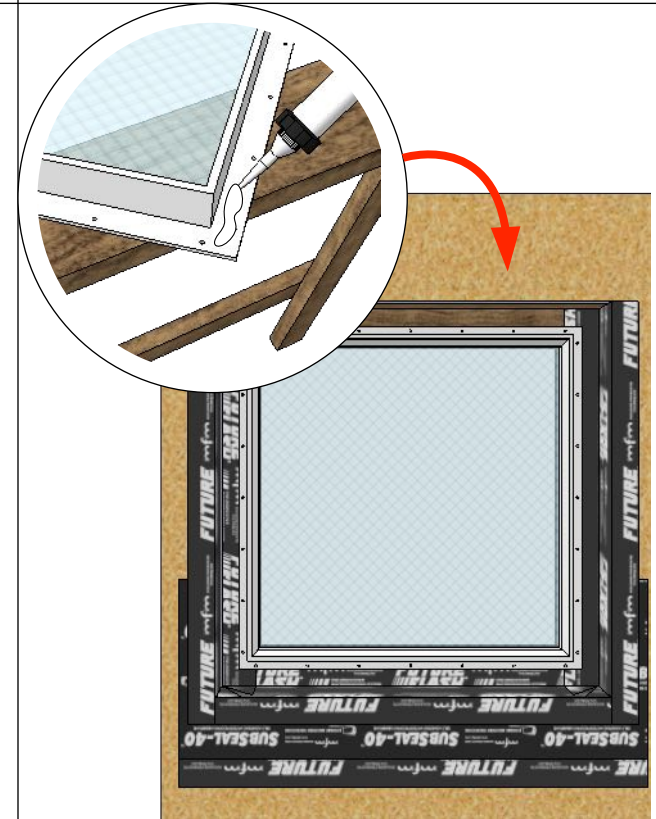

NOTE:

Install your window into the RO.
Follow the window manufacturer's instructions.
Apply 1/2" bead of sealant behind the nail fin. If a membrane pan will be used, leave two 3-4" gaps in sealant at the lower two corners

STEP 10

Buttered Sealant on top of Nail Fin

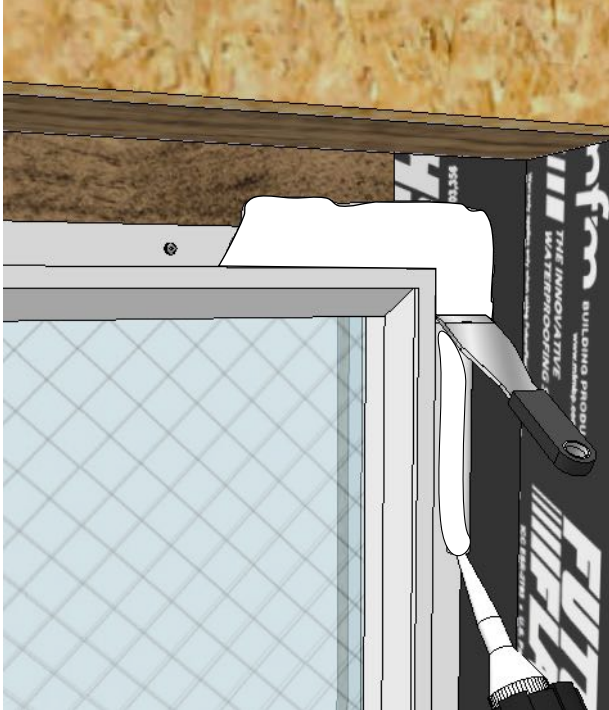

NOTE:

APPLY 1/2" BEAD OF SEALANT ON TOP OF WINDOW NAIL FIN ON ALL 4 SIDES AND BUTTER FLAT W/ PUTTY KNIFE. ALL FASTENERS ARE COMPLETELY COVERED WITH SEALANT. USE FUTURE FLASH SEALANT BY MFM.

STEP 11

Apply Top Corners- GS 108A with Pig Ear Fold

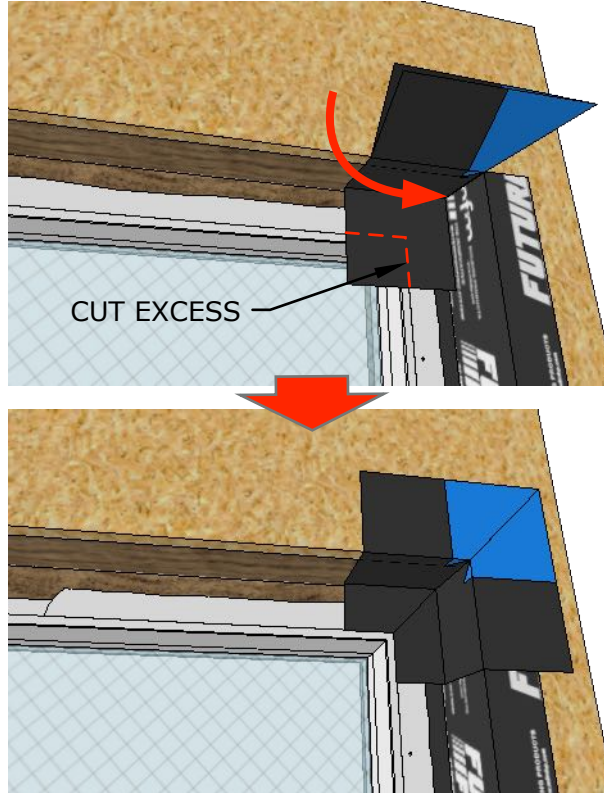

NOTE:

Apply the top corners into wet sealant. Create the inside corner by folding the GS 108A using the Pig Ear fold. Staple the corner to hold it in place.

STEP 12

Apply SubSeal 40 across the top

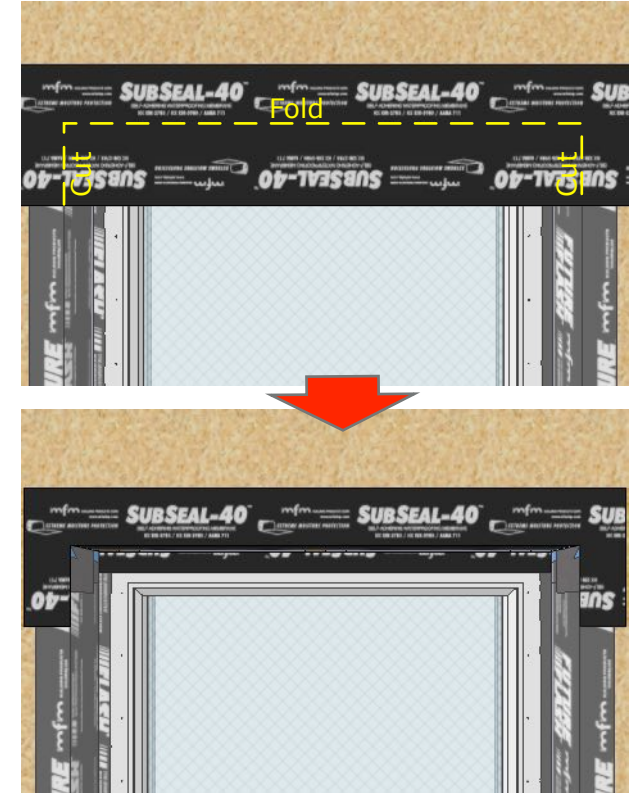

NOTE:

Apply 12" or larger (depending on recess depth) SubSeal 40 as shown. Position it so that the membrane will terminate on the top of the window.

Use a J-Roller and J-Roll the material flat. Eliminate wrinkles and ensure complete adhesion.

STEP 13

Apply Future Flash Sealant

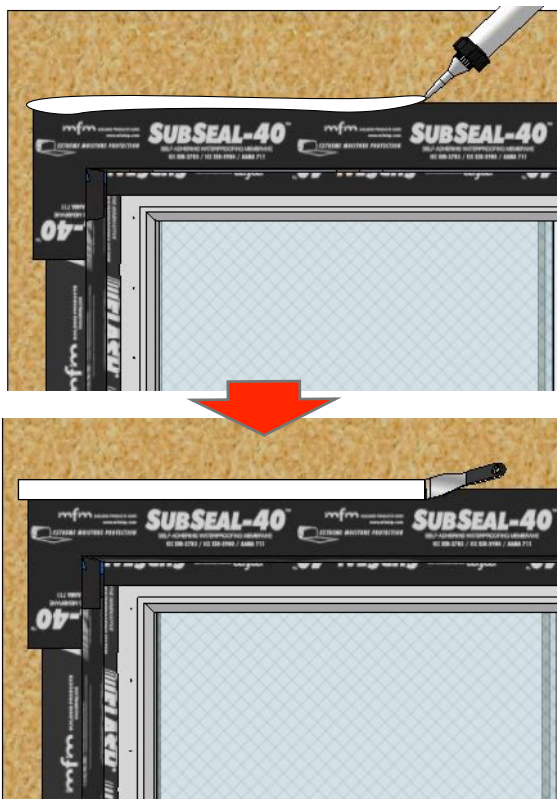

NOTE:

Apply staples across the top edge of the membrane to hold it in place.
Apply a 1/2" bead of sealant across the top edge of the membrane and butter it flat. This will protect the assembly in case of rain during construction.
This also protects against the gaps in the seams of the OSB sheathing.
Use Future Flash Sealant

STEP 14

Buttered Sealant

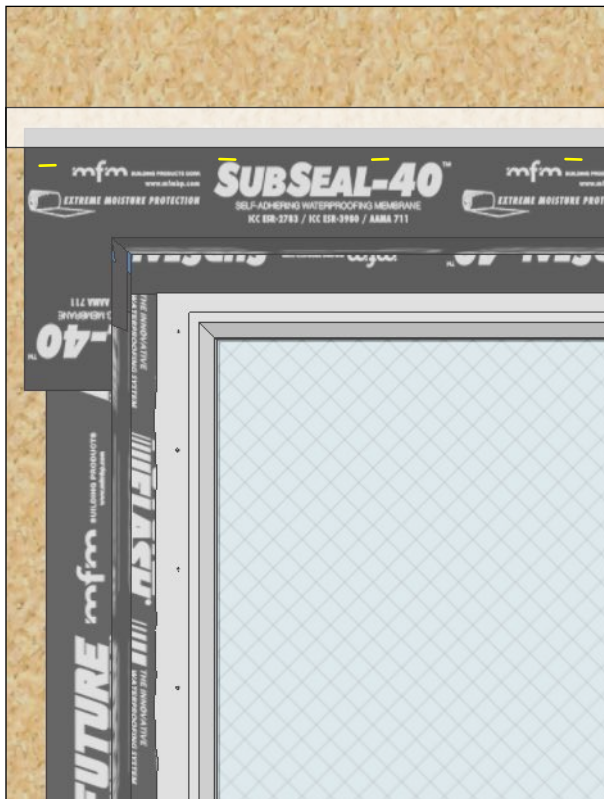

NOTE:

This is the way the top should look when complete.

ALL DONE!

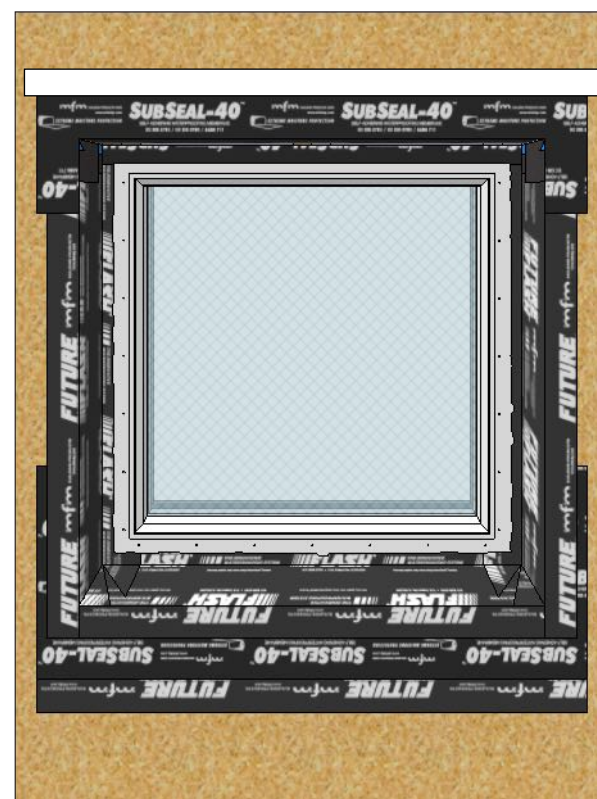

NOTE:

Your completed assembly should look like this when complete.

SECTION DETAILS

SILL SECTION

This detail reflects the use of a Ready Sill Pan.
If not using a Ready Sill Pan, apply sealant across the bottom and tool into the window frame across the lower edge of the window and 8" up each side.

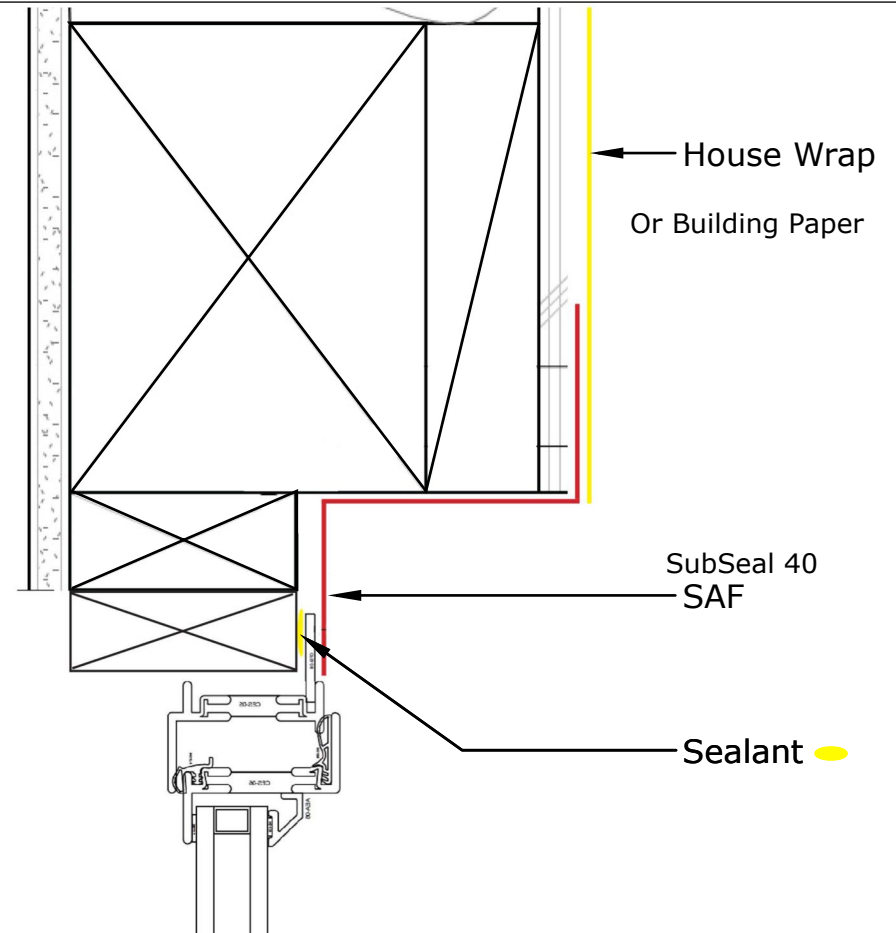
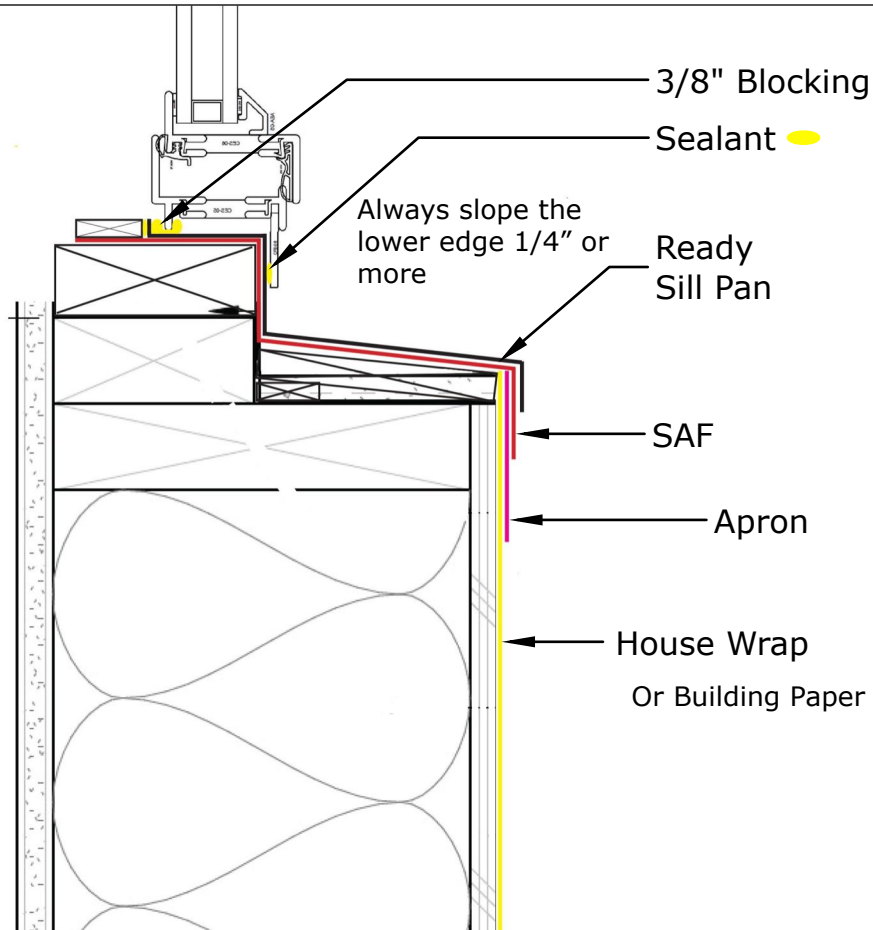

HEADER SECTION