

General Storefront Window Flashing Steps

CORNER FLASH BY TLS LABORATORIES

Important Note: Take measurements for the Storefront window after the Flashing materials have been installed to get reliable sizes.

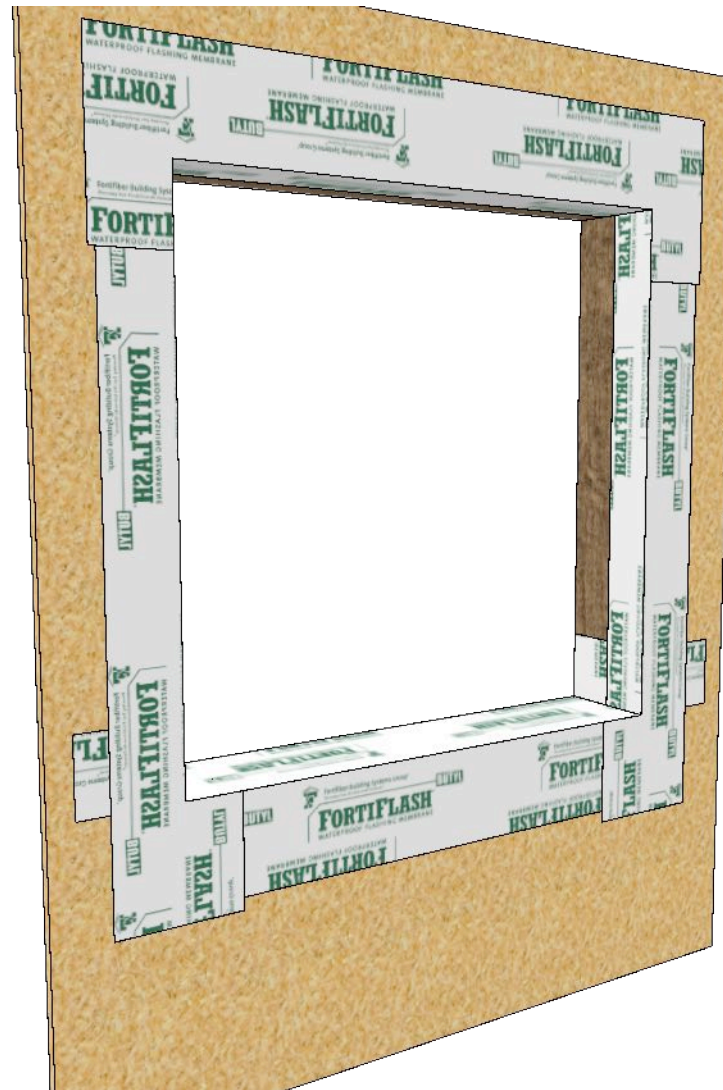

These methods result in qualifying for the Fortishield 15 year warranty. Contact The Fortifiber Building Systems Group for additional information. Call 800 773 4777

Use ONLY the Corner Flash GS 100A Flashing Corners. We suggest Fortiflash Butyl and Moiststop Sealant

PERFORMANCE TESTED



800.310.7673
949.348.9291
info@TLSLabs.com
www.tlslabs.com



Fortifiber Building
Systems Group®

Protecting Your World from the Elements®

STEP 1

Ensure a correct rough opening

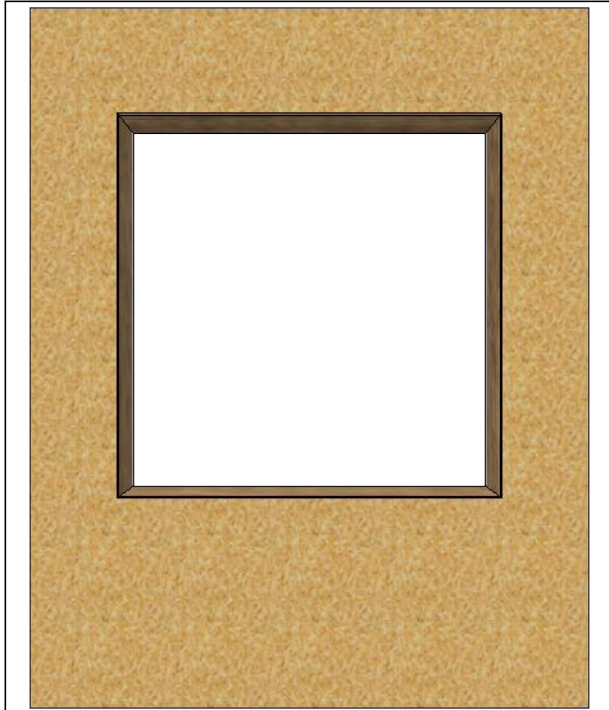

NOTE:

STEP 2

Apply Moistop Sealant

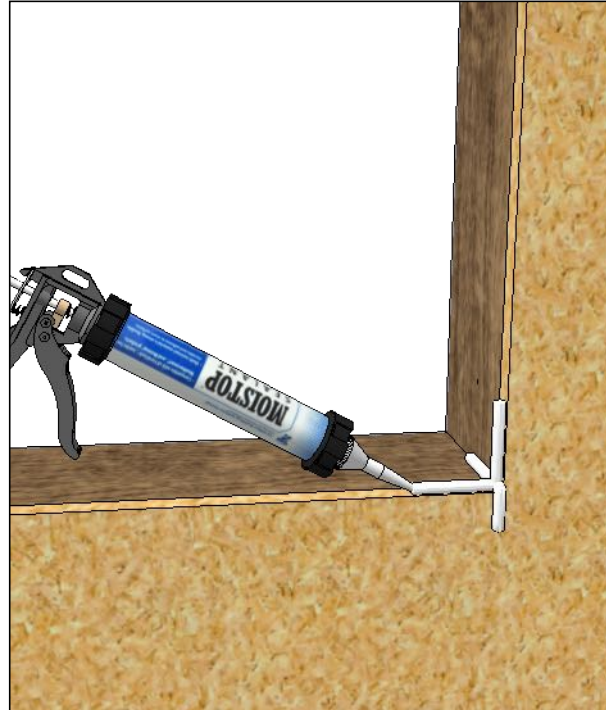

NOTE:

Apply Moistop Sealant as shown

STEP 3

enter title - example:
Apply SAF40

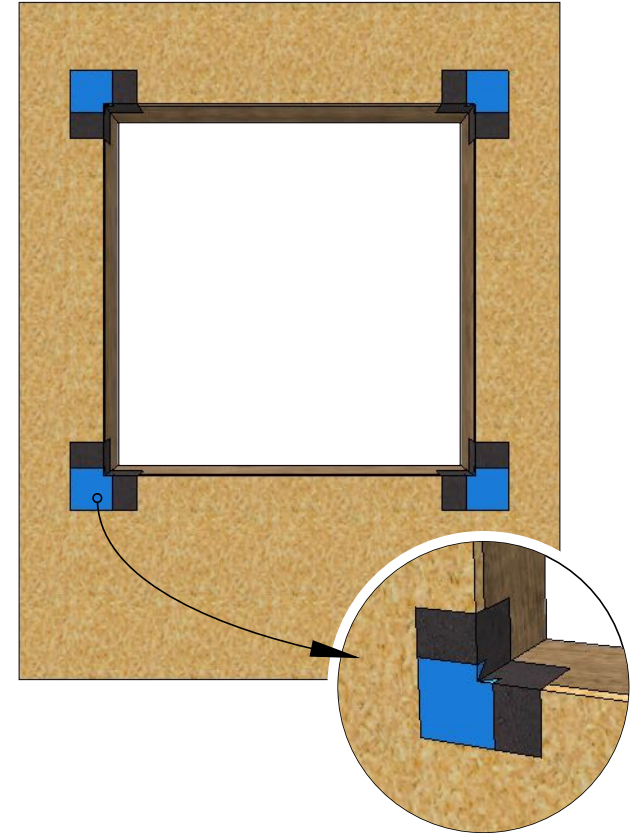

NOTE:

Apply the Corner Flash GS 100A Flashing Corners as shown. Secure with staples.

STEP 4

Lower Course of Fortiflash

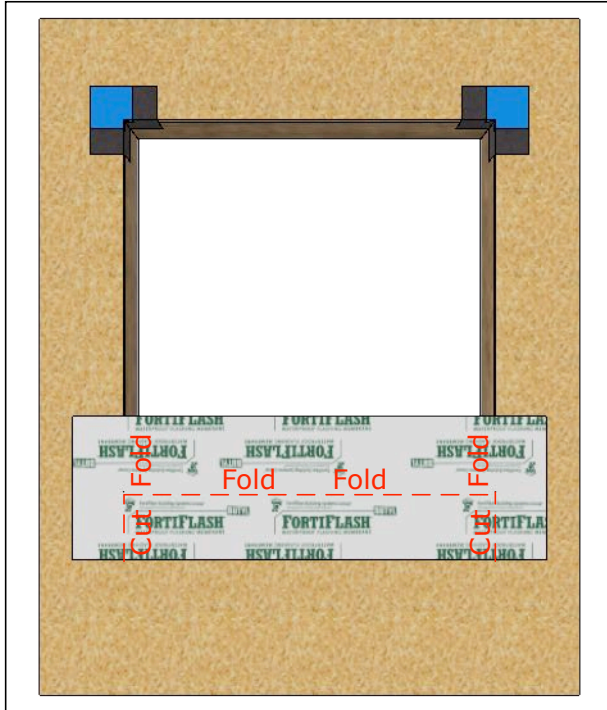

NOTE:

Apply the Fortiflash over the **Corner Flash GS 100 A** corners.
Use primer if required or necessary.

STEP 5

Cut, Fold and J Roll

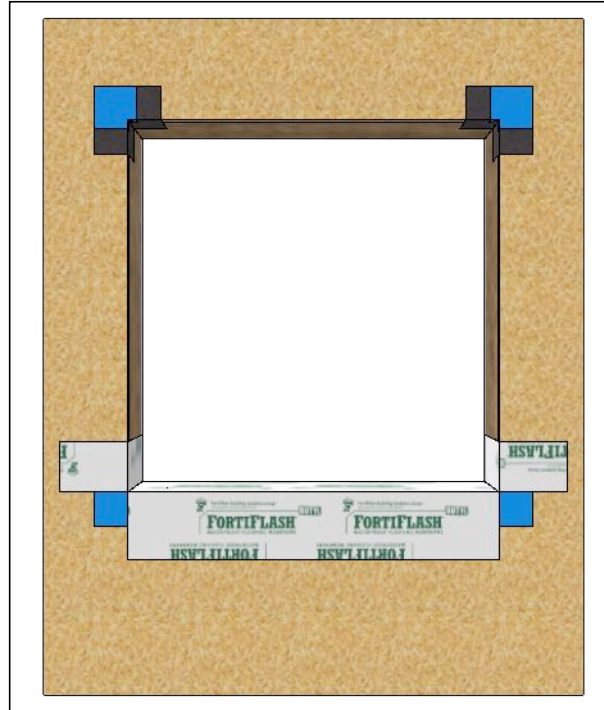

NOTE:

J Roll the Fortiflash Flat.

STEP 6

Side Flashing

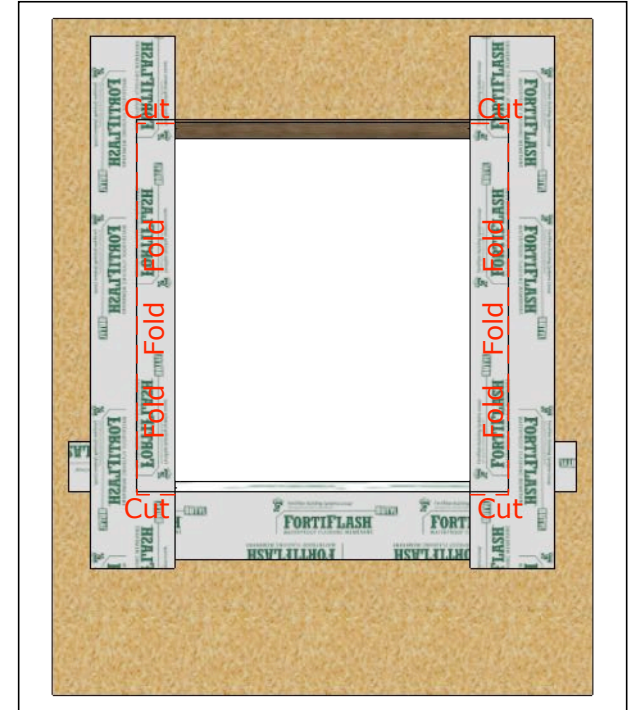

NOTE:

Apply side flashing as shown.

STEP 7

Side Flashing

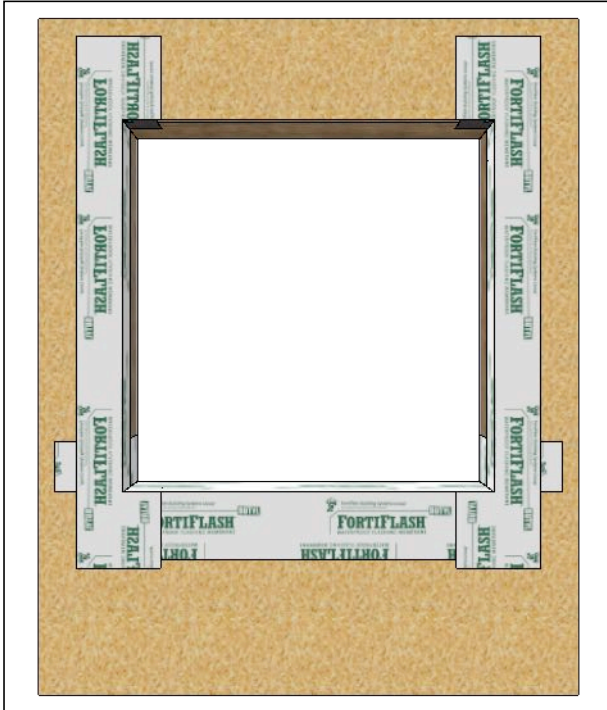

NOTE:

Cut the side flashing to fold into the Rough opening as shown.
J Roll materials flat.
Avoid wrinkles.

STEP 8

Top Flashing

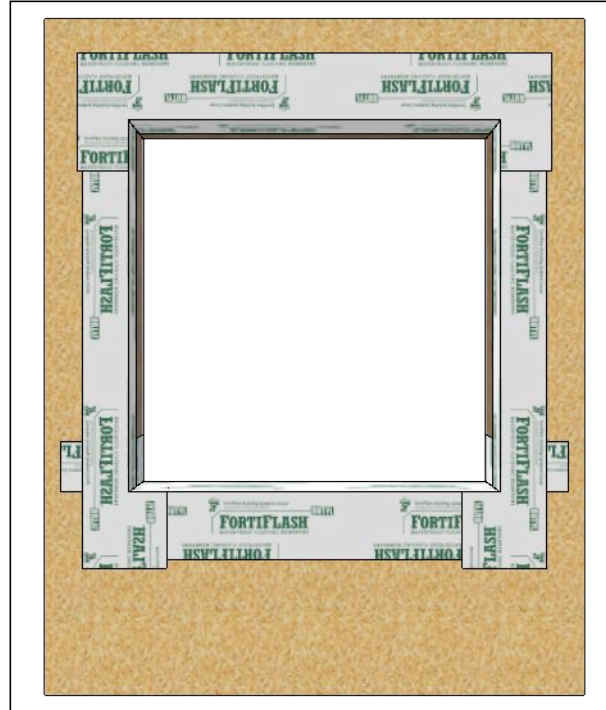

NOTE:

Apply top Flashing, cut and fold into place as shown. Apply staples upwards to prevent material from falling downwards. If steel framing is used, use tape at edges of top flashing to prevent it from falling downwards.

Notes:

NOTE:

1. Take measurements for the window frame assembly after the materials are in place to ensure correct sizing.
2. 3/8" Gap suggested around the entire window frame to ensure sealant performance.
3. Suggest open cell backer rod be used and correctly positioned.
4. Suggest the use of plastic horseshoe shims around the entire assembly.