

TLS LABS VERSION OF AAMA A¹ & B¹ METHODS OF WINDOW INSTALLATION WITH MEMBRANE PAN USING PRE-FORMED CORNERS

"ELIGIBLE FOR FORTISHIELD 10 YEAR WARRANTY BY THE FORTIFIBER BUILDING SYSTEMS GROUP*."

AAMA METHOD A¹

STEP 1 - IS CREATE THE ROUGH OPENING

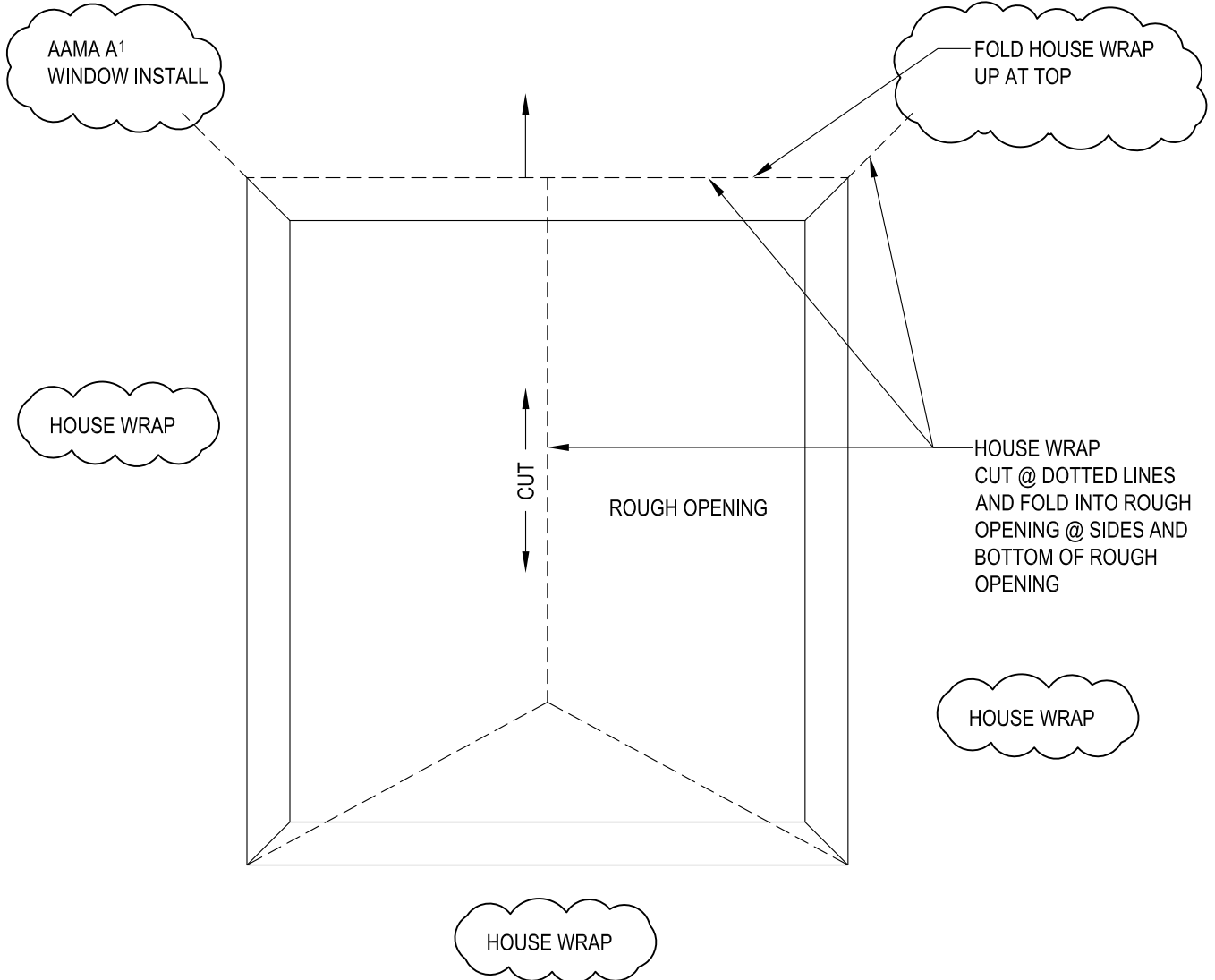

HOUSE WRAP COMPLETELY COVERS ROUGH OPENING

THE FORTIFIBER HOUSE WRAP IS WEATHER - SMART

*ALL FLASHING PRODUCTS, SEALANT PRODUCTS AND WEATHER RESISTIVE BARRIERS MUST BE MANUFACTURED BY THE FORTIFIBER BUILDING SYSTEMS GROUP TO GET THE FORTISHIELD WARRANTY

SAF = SELF ADHERED FLASHING: FORTIFLASH 40, FORTIFLASH OR FORTIFLASH BUTYL

OUTSIDE VIEW

HOUSE WRAP APPLICATION

SCALE: 1"=1'-0"

PAGE 1 OF 9

TLS LABS VERSION OF AAMA A¹ & B¹ METHODS OF WINDOW INSTALLATION WITH MEMBRANE PAN USING PRE-FORMED CORNERS

"ELIGIBLE FOR FORTISHIELD 10 YEAR WARRANTY BY THE FORTIFIBER BUILDING SYSTEMS GROUP*."
AAMA METHOD A¹

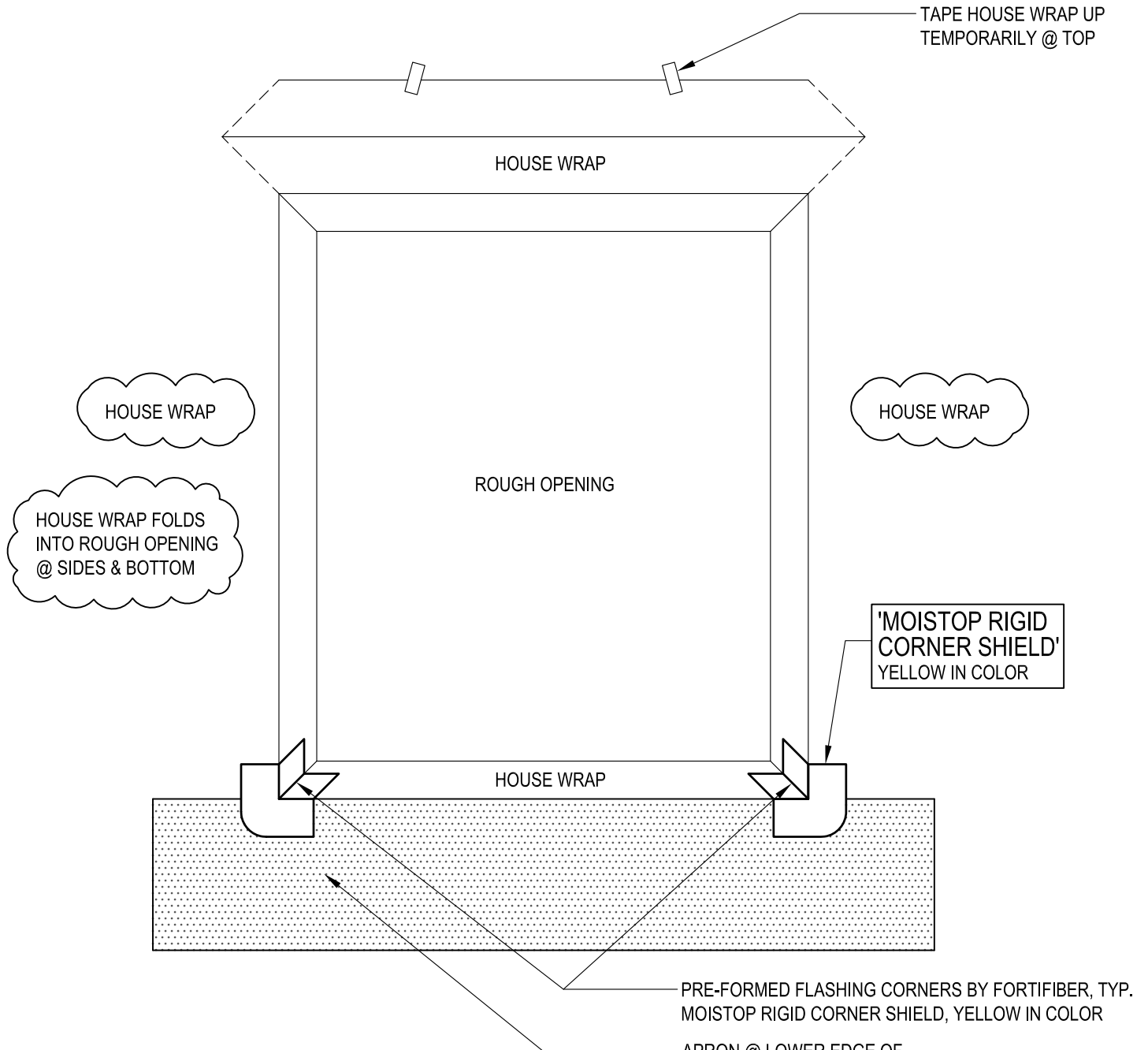

FOR LIGHTNING FLASH CORNERS
CONTACT: TLS LABS @
800.310.7673 or 949.348.9291

PRE-FORMED FLASHING CORNERS BY FORTIFIBER, TYP. MOISTOP RIGID CORNER SHIELD, YELLOW IN COLOR
APRON @ LOWER EDGE OF ROUGH OPENING USE MOISTOP NEXT OR MOISTOP PF IF 2 LAYERS OF WRB BUILDING ENVELOPE IS TO BE USED

*ALL FLASHING PRODUCTS, SEALANT PRODUCTS AND WEATHER RESISTIVE BARRIERS MUST BE MANUFACTURED BY THE FORTIFIBER BUILDING SYSTEMS GROUP TO GET THE FORTISHIELD WARRANTY

SAF = SELF ADHERED FLASHING: FORTIFLASH 40, FORTIFLASH OR FORTIFLASH BUTYL

OUTSIDE VIEW

CUT HOUSE WRAP, APPLY FLASHING CORNERS AND APRON

SCALE: 1"=1'-0"
PAGE 2 OF 9

TLS LABS VERSION OF AAMA A¹ & B¹ METHODS OF WINDOW INSTALLATION WITH MEMBRANE PAN USING PRE-FORMED CORNERS

"ELIGIBLE FOR FORTISHIELD 10 YEAR WARRANTY BY THE FORTIFIBER BUILDING SYSTEMS GROUP*."
AAMA METHOD A¹

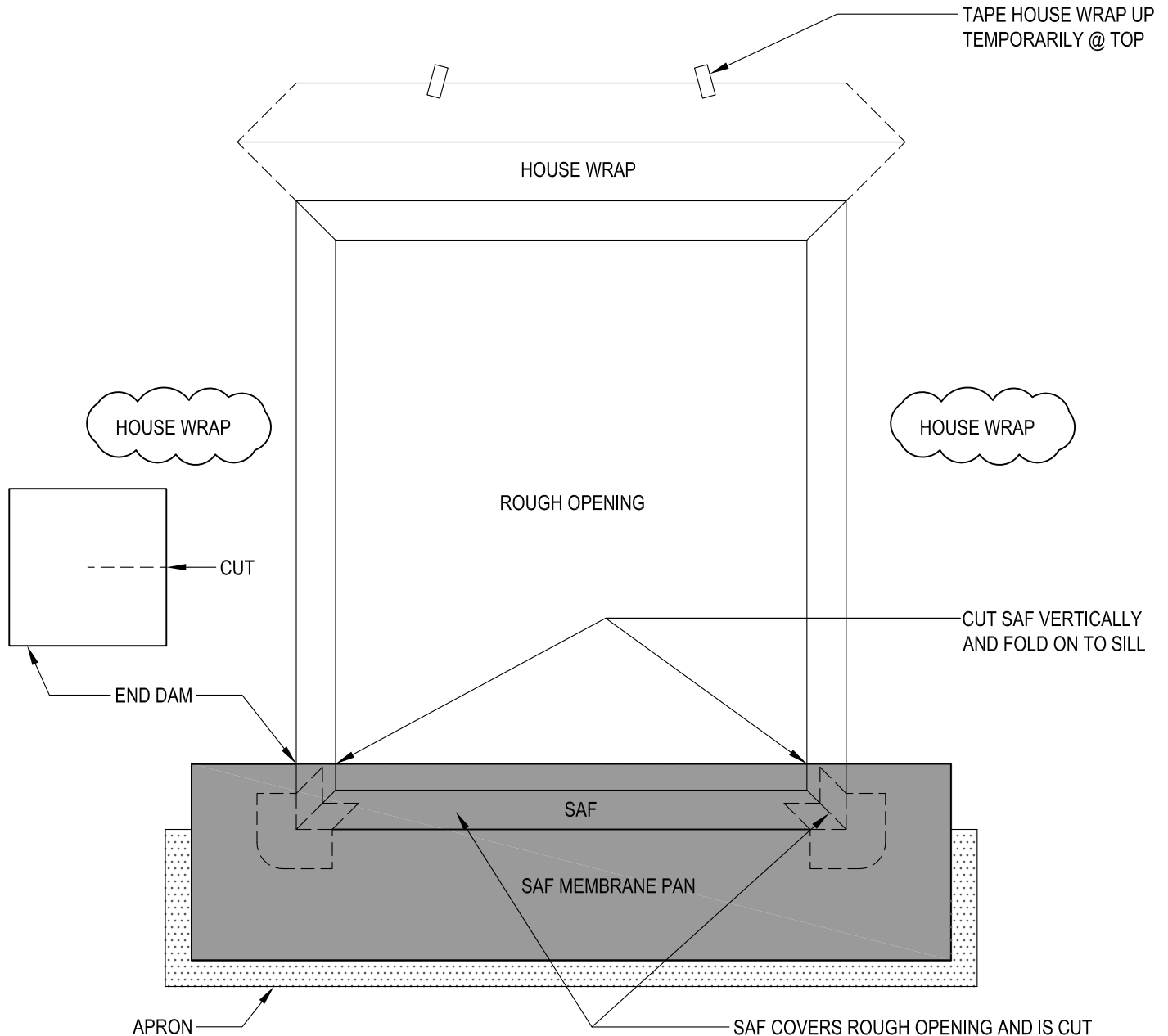

FOR LIGHTNING FLASH CORNERS or J-ROLLERS
CONTACT: TLS LABS @
800.310.7673 or 949.348.9291

SAF COVERS ROUGH OPENING AND IS CUT VERTICALLY TO FOLD ON TO SILL
SAF ON TOP OF CORNERS AND APRON
CUT SQUARE PIECES OF SAF AND USE AS END DAMS ON BOTH LOWER CORNER
J-ROLLER ALL SAF COMPLETELY

*ALL FLASHING PRODUCTS, SEALANT PRODUCTS AND WEATHER RESISTIVE BARRIERS MUST BE MANUFACTURED BY THE FORTIFIBER BUILDING SYSTEMS GROUP TO GET THE FORTISHIELD WARRANTY

SAF = SELF ADHERED FLASHING: FORTIFLASH 40, FORTIFLASH OR FORTIFLASH BUTYL

OUTSIDE VIEW

INSTALL MEMBRANE PAN

SCALE: 1"=1'-0"

PAGE 3 OF 9

TLS LABS VERSION OF AAMA A¹ & B¹ METHODS OF WINDOW INSTALLATION WITH MEMBRANE PAN USING PRE-FORMED CORNERS

"ELIGIBLE FOR FORTISHIELD 10 YEAR WARRANTY BY THE FORTIFIBER BUILDING SYSTEMS GROUP*."

AAMA METHOD A¹

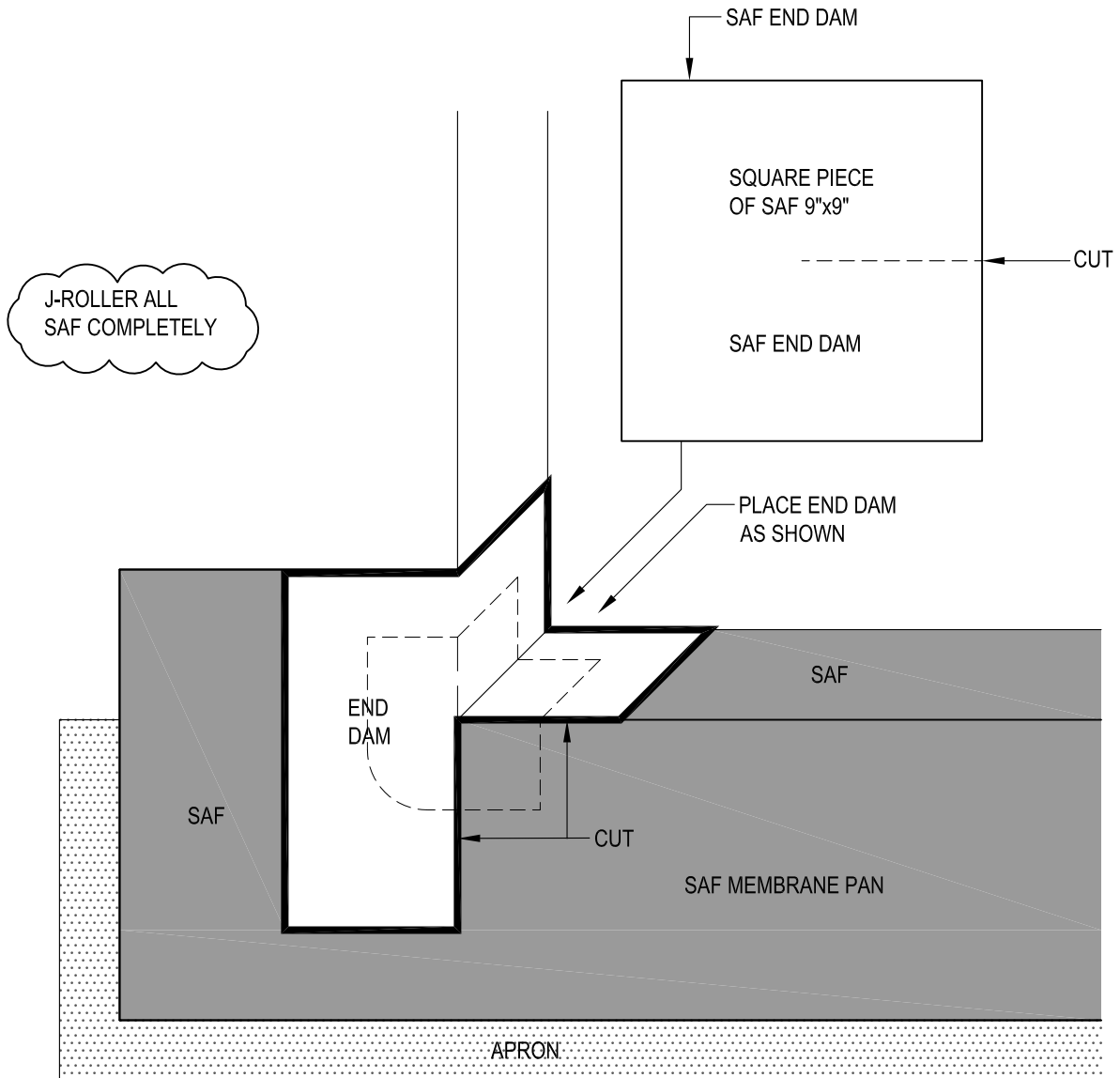

FOR LIGHTNING FLASH CORNERS or J-ROLLERS
CONTACT: TLS LABS @
800.310.7673 or 949.348.9291

*ALL FLASHING PRODUCTS, SEALANT PRODUCTS AND WEATHER RESISTIVE BARRIERS
MUST BE MANUFACTURED BY THE FORTIFIBER BUILDING SYSTEMS GROUP TO GET THE FORTISHIELD WARRANTY

SAF = SELF ADHERED FLASHING: FORTIFLASH 40, FORTIFLASH OR FORTIFLASH BUTYL

OUTSIDE VIEW

EXPANDED VIEW OF CORNER

SCALE: NONE

PAGE 4 OF 9

TLS LABS VERSION OF AAMA A¹ & B¹ METHODS OF WINDOW INSTALLATION WITH MEMBRANE PAN USING PRE-FORMED CORNERS

"ELIGIBLE FOR FORTISHIELD 10 YEAR WARRANTY BY THE FORTIFIBER BUILDING SYSTEMS GROUP*."
AAMA METHOD A¹

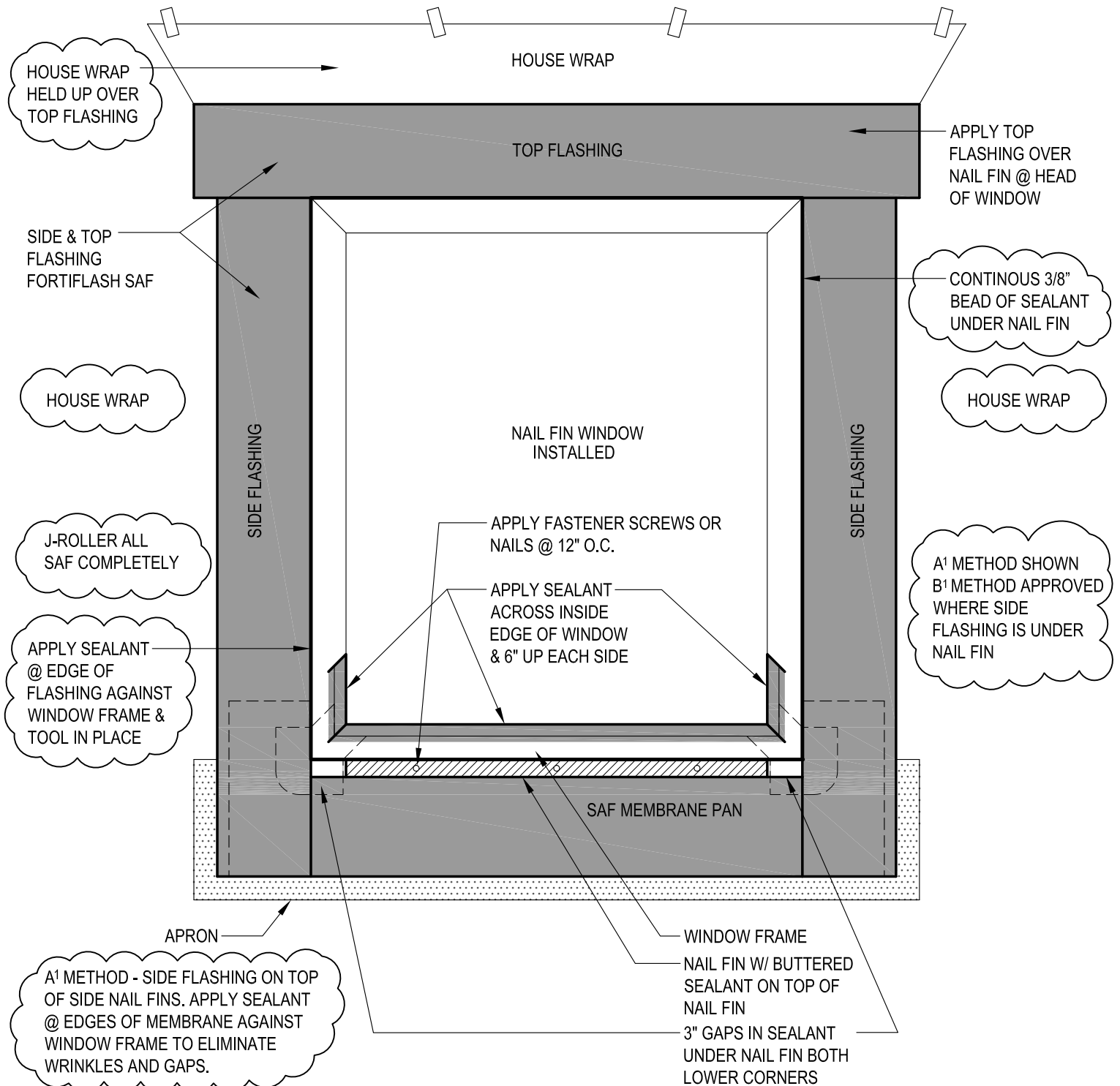

*ALL FLASHING PRODUCTS, SEALANT PRODUCTS AND WEATHER RESISTIVE BARRIERS MUST BE MANUFACTURED BY THE FORTIFIBER BUILDING SYSTEMS GROUP TO GET THE FORTISHIELD WARRANTY

SAF = SELF ADHERED FLASHING: FORTIFLASH 40, FORTIFLASH OR FORTIFLASH BUTYL

OUTSIDE VIEW

APPLY TOP & SIDE FLASHING AFTER WINDOW IS SET

SCALE: 1"=1'-0"

PAGE 5 OF 9

TLS LABS VERSION OF AAMA A1 & B1 METHODS OF WINDOW INSTALLATION WITH MEMBRANE PAN USING PRE-FORMED CORNERS

"ELIGIBLE FOR FORTISHIELD 10 YEAR WARRANTY BY THE FORTIFIBER BUILDING SYSTEMS GROUP*."

AAMA METHOD A1

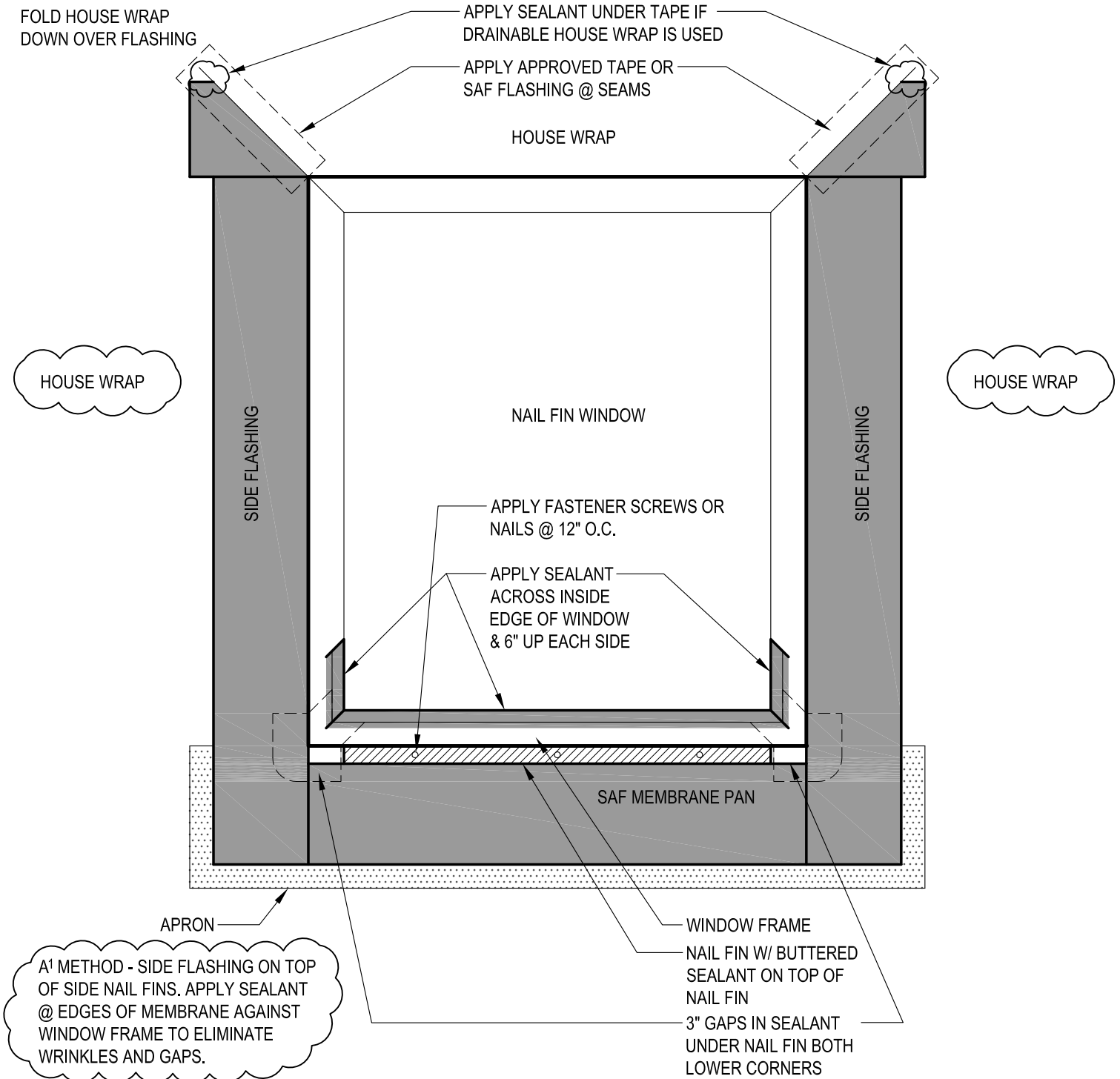

*ALL FLASHING PRODUCTS, SEALANT PRODUCTS AND WEATHER RESISTIVE BARRIERS MUST BE MANUFACTURED BY THE FORTIFIBER BUILDING SYSTEMS GROUP TO GET THE FORTISHIELD WARRANTY

SAF = SELF ADHERED FLASHING: FORTIFLASH 40, FORTIFLASH OR FORTIFLASH BUTYL

OUTSIDE VIEW

FOLD HOUSE WRAP DOWN OVER FLASHING

SCALE: 1"=1'-0"

TLS LABS VERSION OF AAMA A¹ & B¹ METHODS OF WINDOW INSTALLATION WITH MEMBRANE PAN USING PRE-FORMED CORNERS

"ELIGIBLE FOR FORTISHIELD 10 YEAR WARRANTY BY THE FORTIFIBER BUILDING SYSTEMS GROUP*."
AAMA METHOD A¹

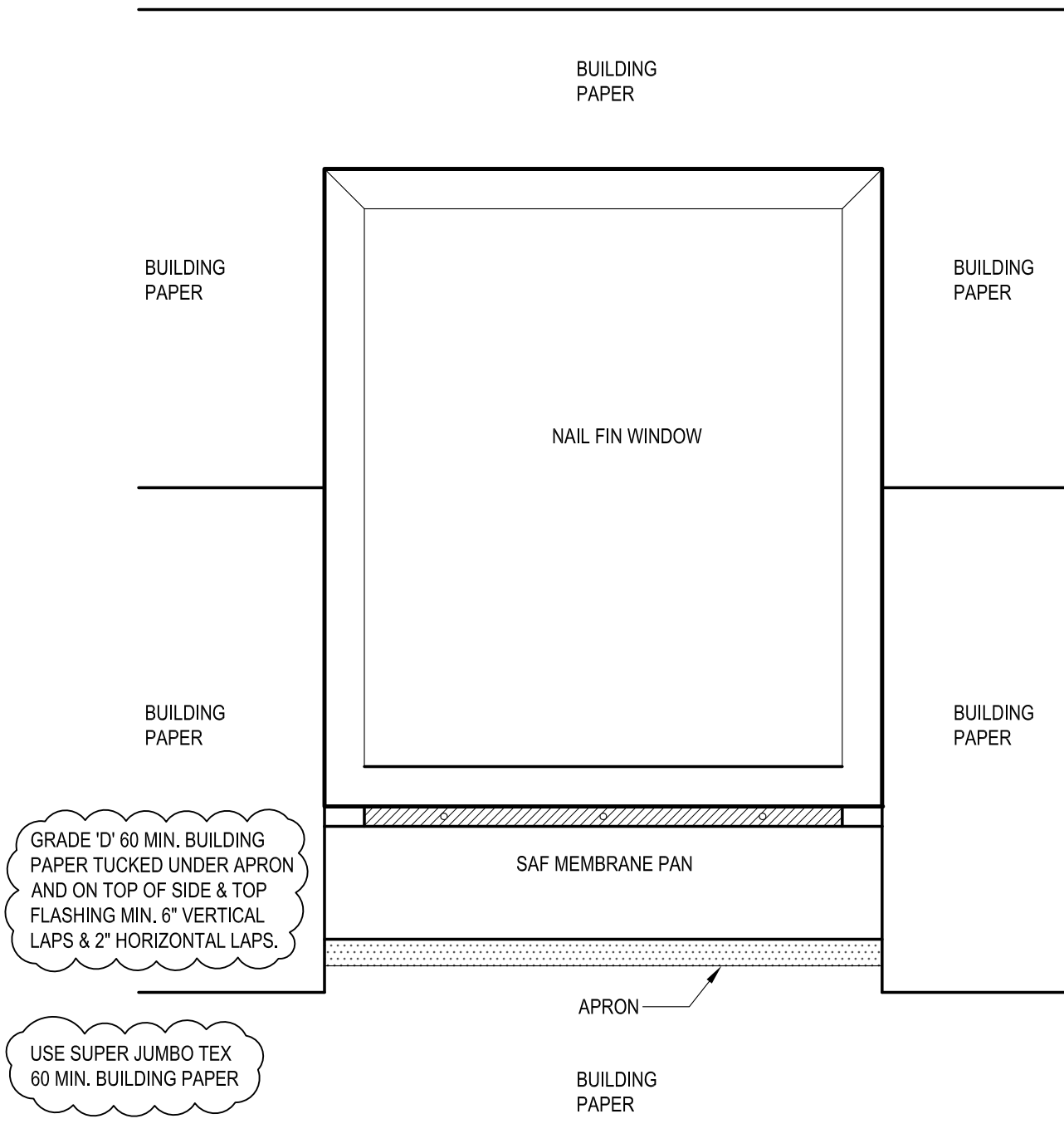

*ALL FLASHING PRODUCTS, SEALANT PRODUCTS AND WEATHER RESISTIVE BARRIERS MUST BE MANUFACTURED BY THE FORTIFIBER BUILDING SYSTEMS GROUP TO GET THE FORTISHIELD WARRANTY

SAF = SELF ADHERED FLASHING: FORTIFLASH 40, FORTIFLASH OR FORTIFLASH BUTYL

OUTSIDE VIEW

BUILDING PAPER APPLIED AFTER WINDOW IS SET IN PLACE & FLASHED

SCALE: 1"=1'-0"
PAGE 7 OF 9

TLS LABS VERSION OF AAMA A¹ & B¹ METHODS OF WINDOW INSTALLATION WITH MEMBRANE PAN USING PRE-FORMED CORNERS

"ELIGIBLE FOR FORTISHIELD 10 YEAR WARRANTY BY THE FORTIFIBER BUILDING SYSTEMS GROUP*."

AAMA METHOD A¹ ALTERNATIVE

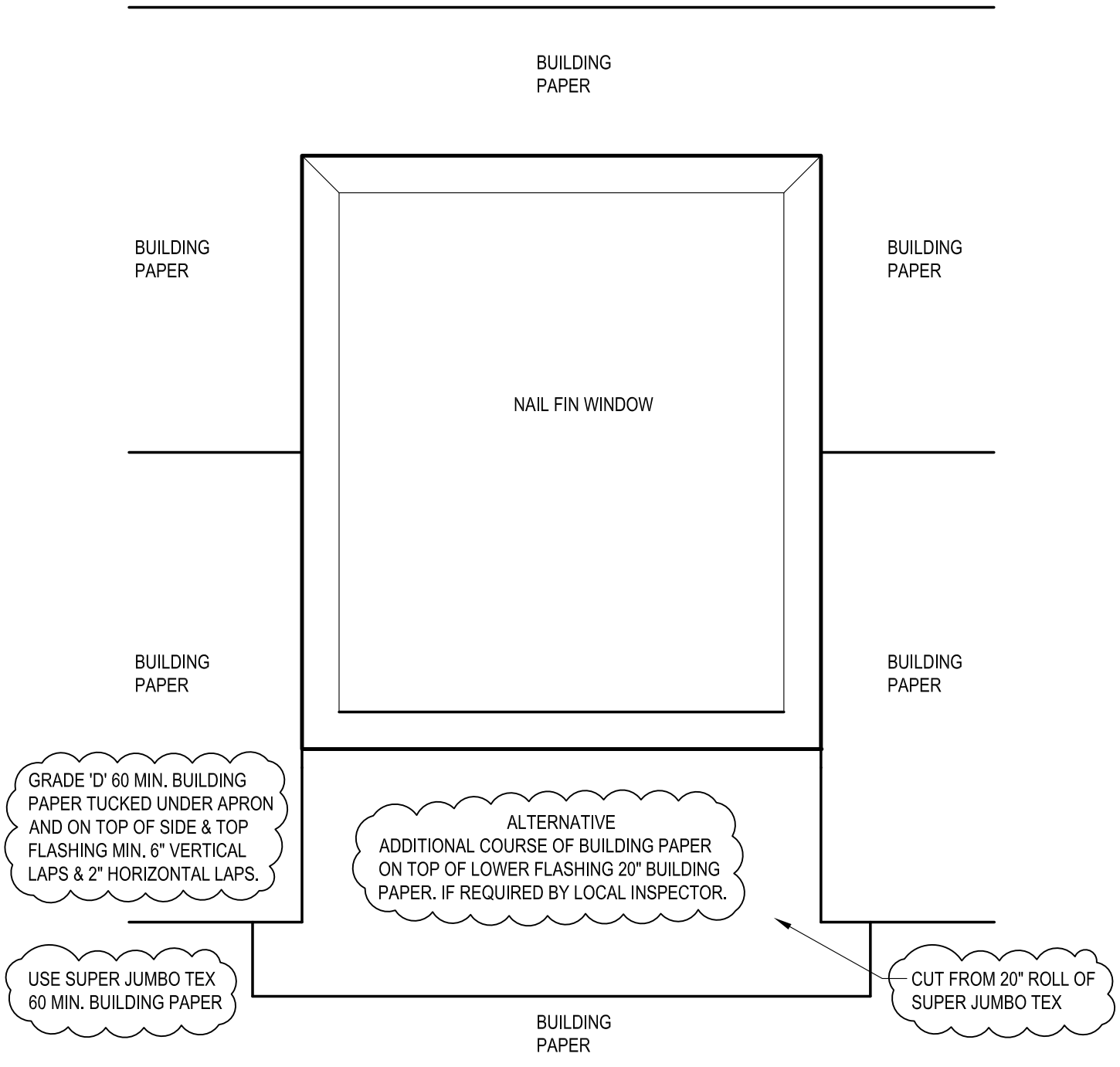

*ALL FLASHING PRODUCTS, SEALANT PRODUCTS AND WEATHER RESISTIVE BARRIERS MUST BE MANUFACTURED BY THE FORTIFIBER BUILDING SYSTEMS GROUP TO GET THE FORTISHIELD WARRANTY

SAF = SELF ADHERED FLASHING: FORTIFLASH 40, FORTIFLASH OR FORTIFLASH BUTYL

OUTSIDE VIEW

BUILDING PAPER APPLIED AFTER WINDOW IS SET IN PLACE & FLASHED

SCALE: 1"=1'-0"
PAGE 8 OF 9

TLS LABS VERSION OF AAMA A¹ & B¹ METHODS OF WINDOW INSTALLATION WITH MEMBRANE PAN USING PRE-FORMED CORNERS

"ELIGIBLE FOR FORTISHIELD 10 YEAR WARRANTY BY THE FORTIFIBER BUILDING SYSTEMS GROUP*."

AAMA METHOD A¹

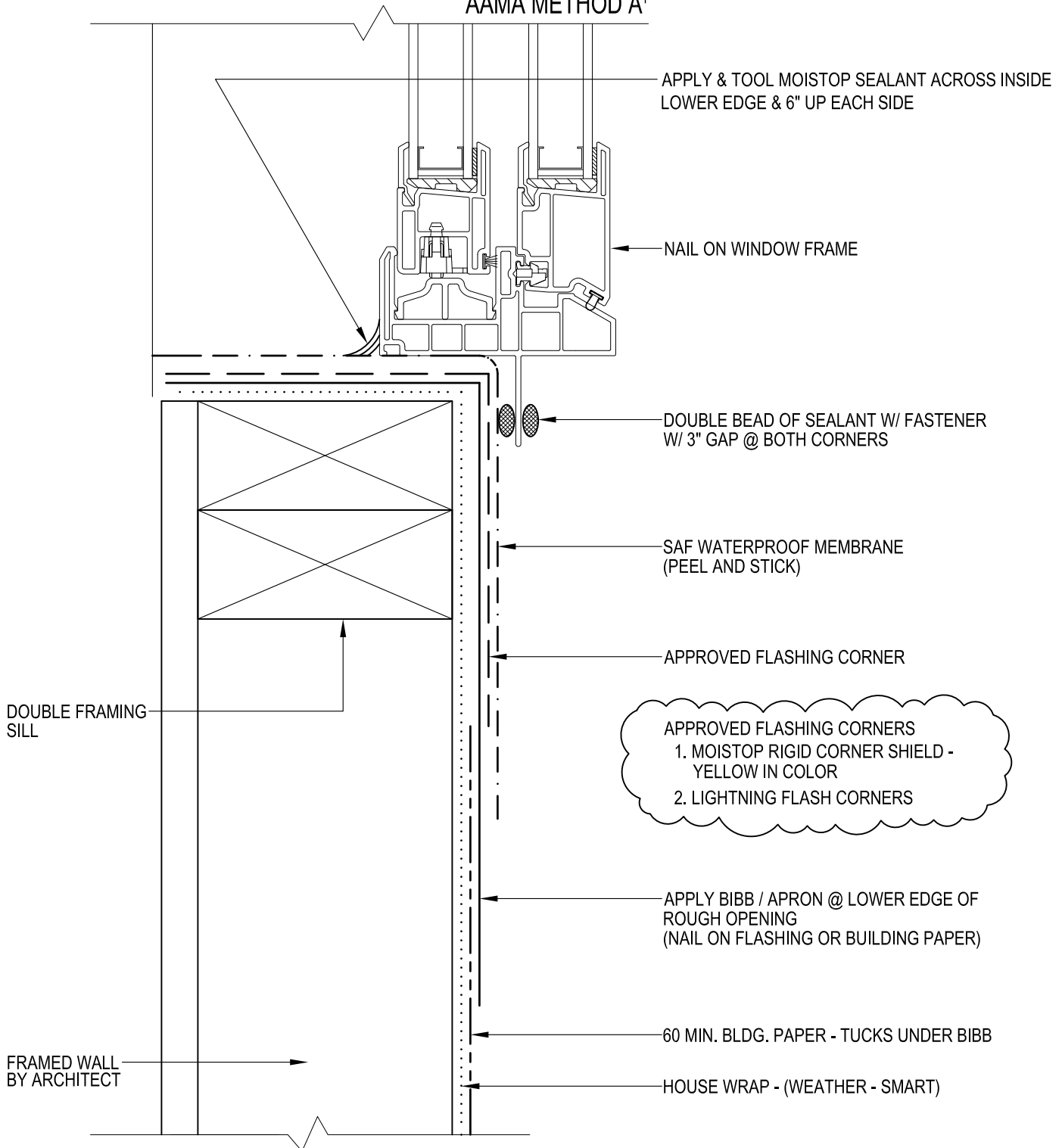

*ALL FLASHING PRODUCTS, SEALANT PRODUCTS AND WEATHER RESISTIVE BARRIERS MUST BE MANUFACTURED BY THE FORTIFIBER BUILDING SYSTEMS GROUP TO GET THE FORTISHIELD WARRANTY

SAF = SELF ADHERED FLASHING: FORTIFLASH 40, FORTIFLASH OR FORTIFLASH BUTYL

WINDOW SILL

SCALE: 6"=1'-0"